

BD SurePath Vial Collection Change

From the 1st of April 2014, the Cytology SurePath vial will change. The vial will remain the same size but has a new addition of a plastic structure inside the vial. There are some minor changes to the lid and container design.

The existing (old) SurePath vials can continue being used and will be accepted for processing in the laboratory – there will be a gradual transition to the new vials over a few weeks.

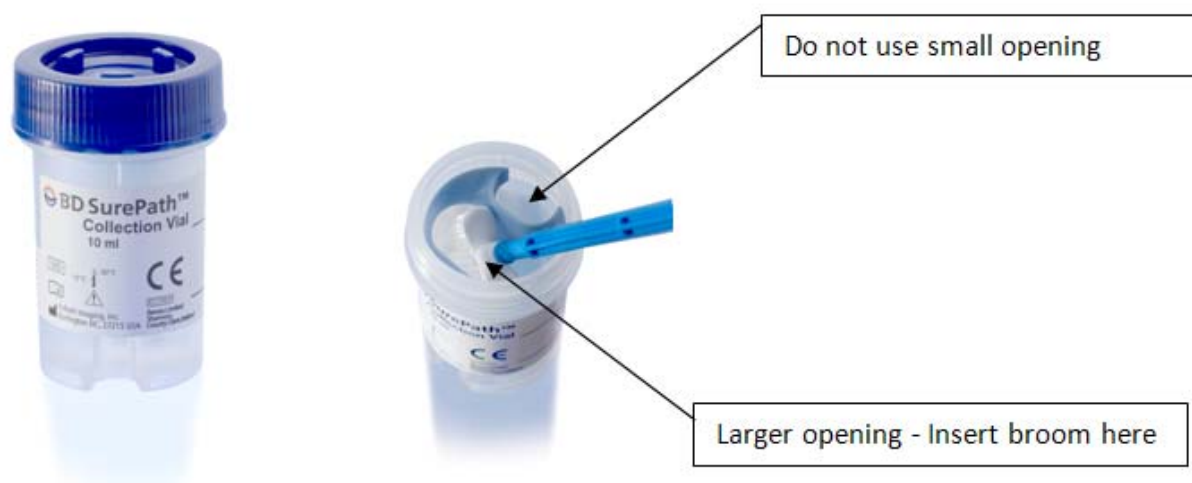

1. Collect the sample in the usual manner
2. Use the **larger opening** of the internal plastic structure to hold and detach head of sampling device (broom)
3. If a brush is also being used, snap off head and place in the **larger opening**
4. Replace cap firmly

For further information please contact Abed Kader, Cytology Head of Department

Phone: 04 381 5915

Email: akader@apath.co.nz